

Installation Guide – Common Models



Installation Guide

➔ Applied Models

- Preparation
- How to Install
- Finish

E-Smart Lock

ZP100



ZP200R / ZP200WR



PT200TWR



PT300BR / PT300BWR



PT600B



PT600TWR



SL200TWR



SL600TWR



SL600EWR



Installation Guide

- Applied Models

Preparation

- How to Install
- Finish

E-Smart Lock

1-1 Product

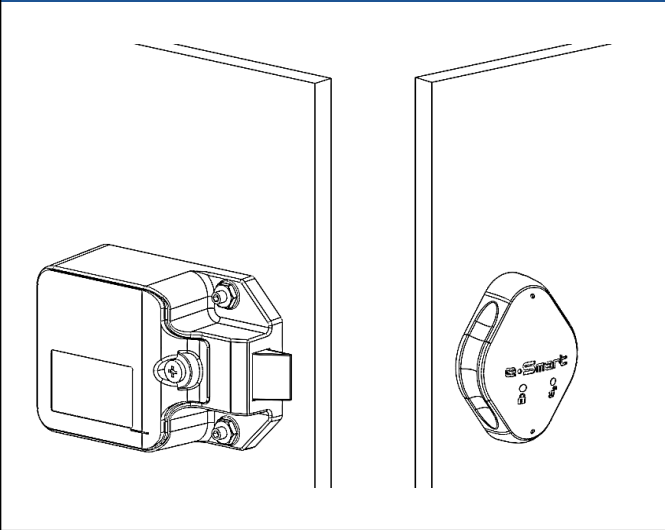

1-1 : Product

1-2 : Drill, Spanner(Wrench)

1-3 : Hole guide lines

1-2 Necessary Tools

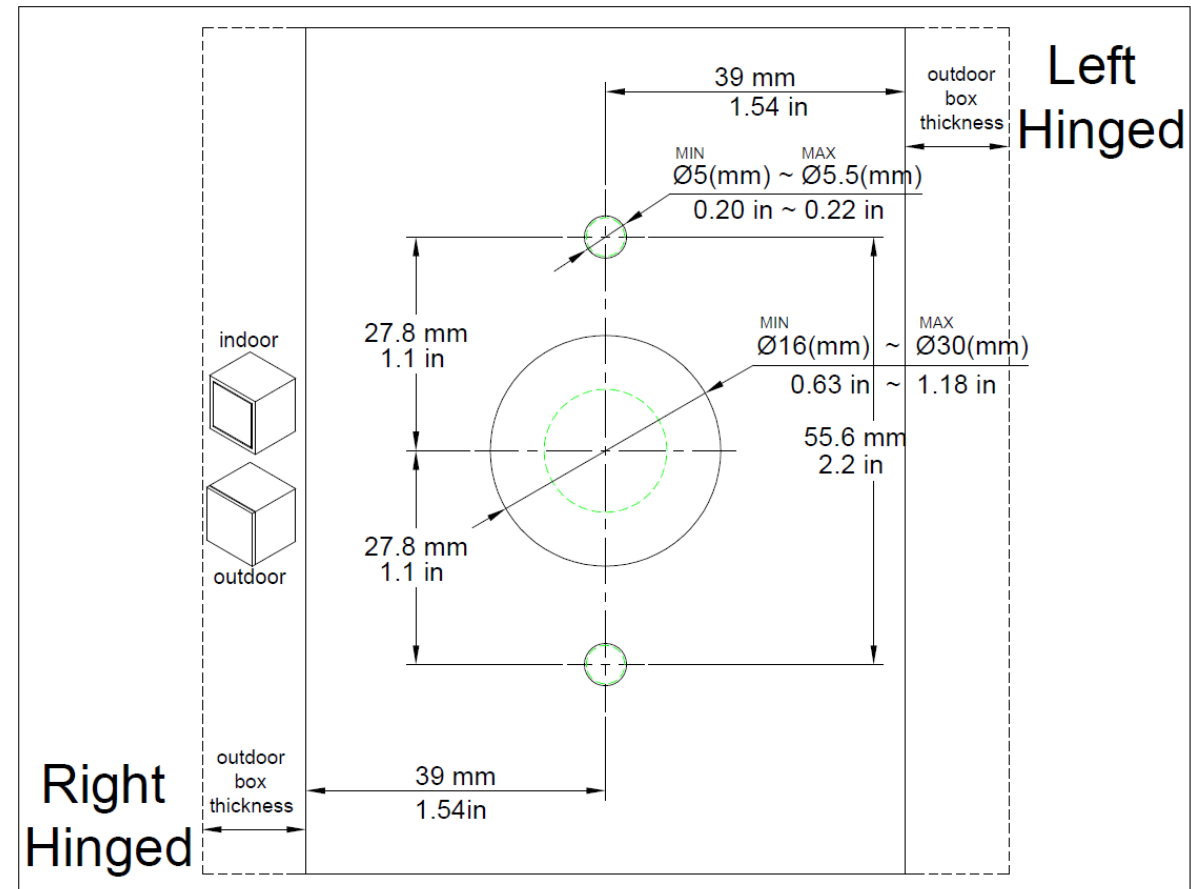
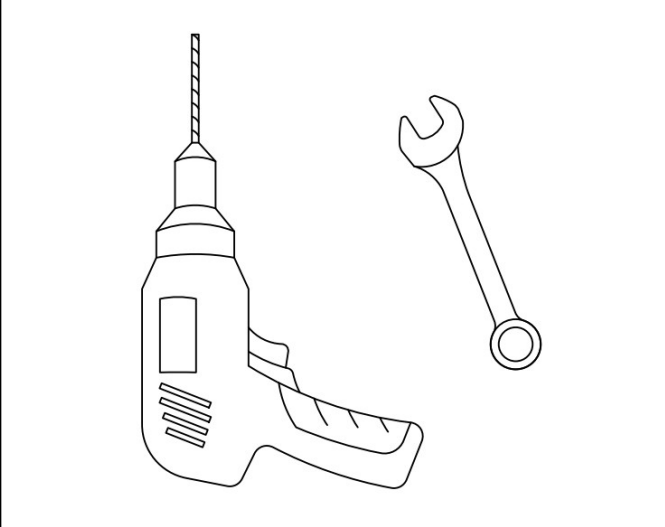

Installation Guide

- Applied Models
- Preparation
- ➔ **How to Install**
- Finish

E-Smart Lock

2-1 Lock products

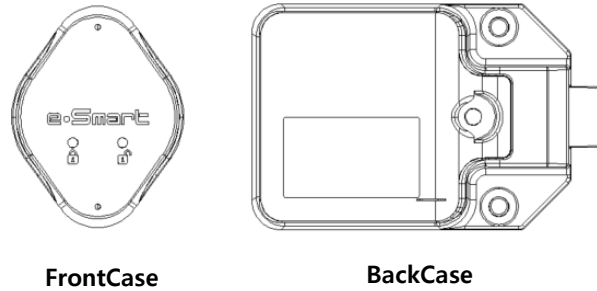

2-2 Installation parts

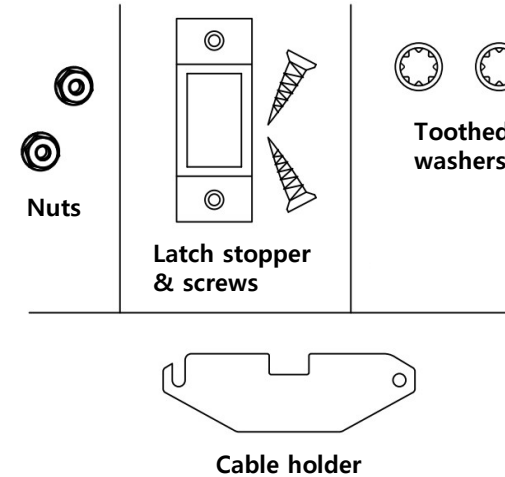

2-3 Locker installation concept

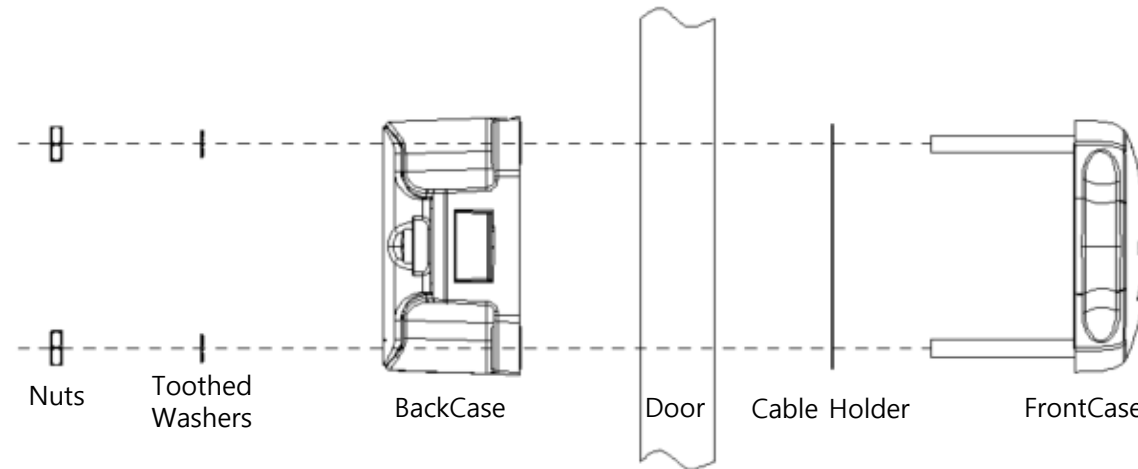

2-1 : Lock Product – FrontCase 1EA , BackCase 1EA

2-2 : Installation Parts –
Nuts 2EA , Latch Stopper 1EA ,
Screw 2EA ,
Toothed washer 2EA ,
Cable Holder 1EA

2-3 : Lock Installation Concept –
The Front case and cable holder
are located at the front of the
door.
Back case, nuts, and toothed
washers are located at the back.

Installation Guide

- Applied Models
- Preparation
- ➔ **How to Install**
- Finish

E-Smart Lock

3-1 Drill holes on the door

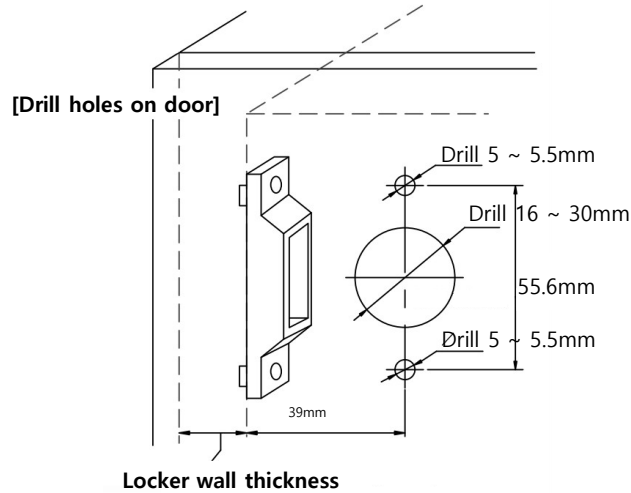

3-2 Latch stopper center line

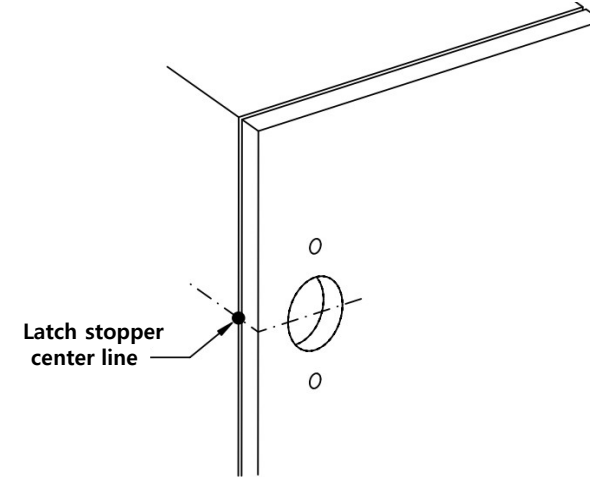

3-1 : Drill holes on the door

3-2 : Mark on a center line of a Latch Stopper

3-3 Mount a latch stopper

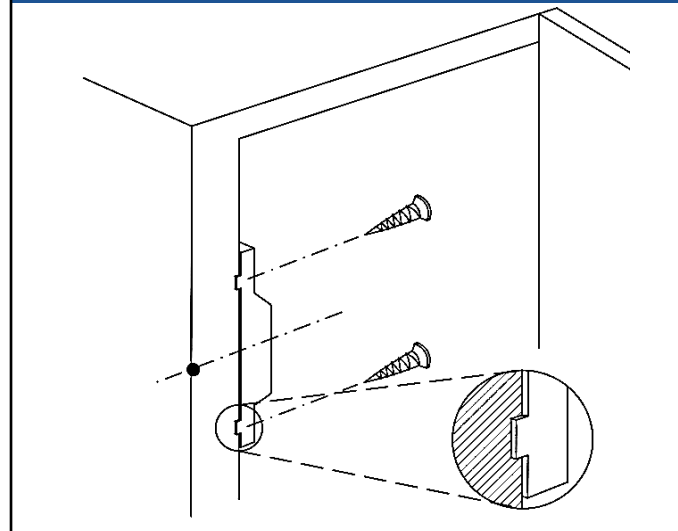

3-4 Assemble a Back Case

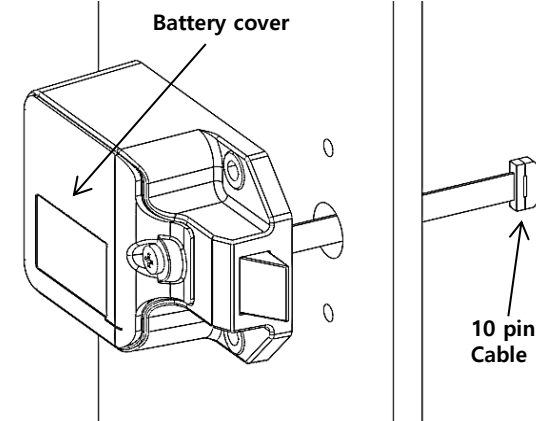

3-3 : Install a product using the center line of the Latch Stopper as a guide (Screw Up and Down)

3-4 : Install the four AA batteries into the Back Case, close the battery cover, and tighten the screws. Insert the 10-pin cable across the center hole in the door.

Installation Guide

- Applied Models
- Preparation
- ➔ **How to Install**
- Finish

E-Smart Lock

4-1

Assemble a Front Case

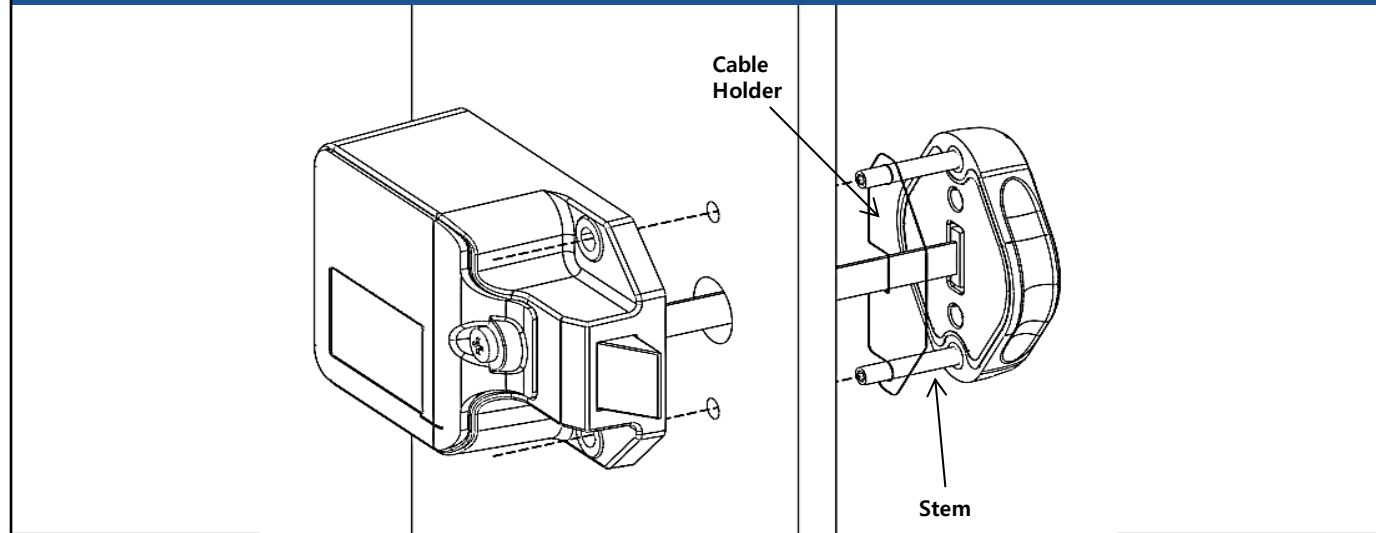

4-1 : After securing the Back Case to prevent it from moving, connect the 10-pin cable to the Front Case. Once the cable is connected, insert the cable holder into the stem to mount it.

4-2

Assemble Accessories

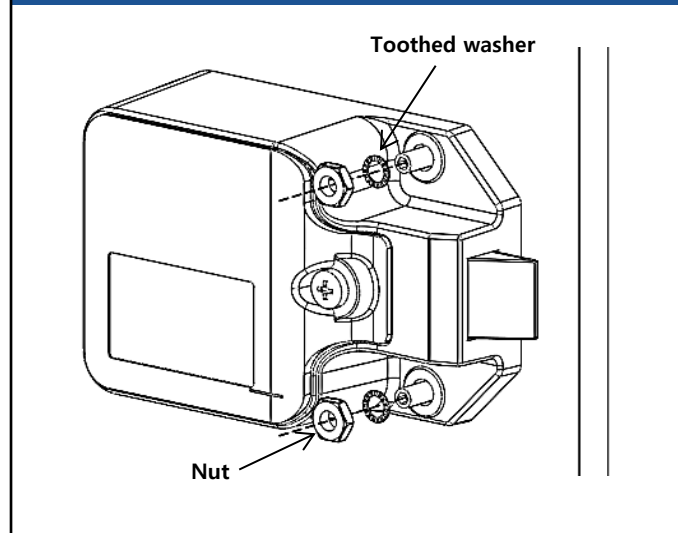

4-2 : Install the toothed washers and nuts on the top and bottom of the stem. Turn the nuts and washers clockwise with a 10mm spanner(wrench) to keep them tight.

Installation Guide

- Applied Models
- Preparation
- How to Install

Finish

E-Smart Lock

5-1

Finish

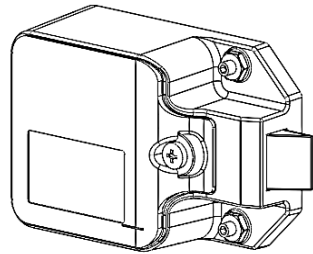

Once the installation is complete, make sure the door is locked properly and check for slight wobbles when moving the door back and forth.

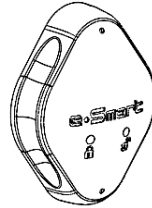

5-2

Caution

→ Door opening direction
→

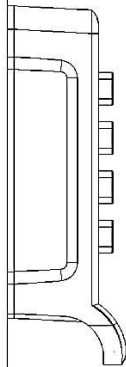

After locking the lock, pull the door in the direction of opening to make sure there is a 2mm gap between the door and the frame.

After locking the lock, grab the Front Case and try moving it. (forward, backward) The door should have some movement.

- Gaps smaller than 2 mm might cause a latch jamming when the lock is actuated.

