

Install Guide

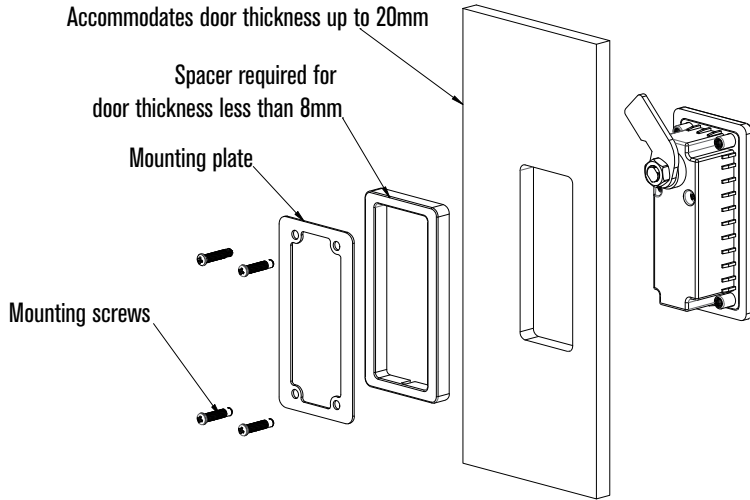

Through hole dimensions

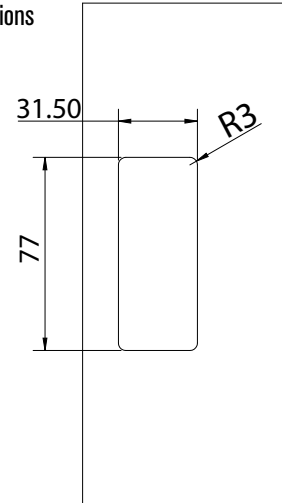

Door thickness (mm)	Screw type	Spacer required
0 - 5	M3X10	✓
5 - 8	M3X14	✓
8 - 12	M3X10	
12 - 16	M3X14	
16 - 20	M3X18	

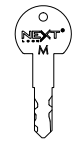

Manager key

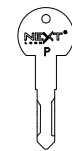

Programming key

Assign a User Code

(factory default code = 0-0-0-0)

1. Set the dial to show the current user code.
2. Insert the Programming Key and turn the knob to the position.
3. Set any 4-digit code.
4. Turn the knob to the position and remove the Programming key.
5. Scramble the code.

Once a new user code is assigned, the previously assigned user code will no longer operate the lock.

If the current user code is unknown, follow the [Reset Instructions](#) to assign a new user code.

Note: Removing the Programming Key in the position will remove the core. See [Change Core Instructions](#) to reinsert the core.

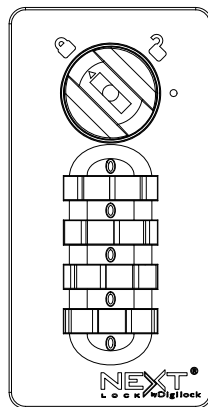

Operate with the Manager Key

To Unlock:

1. Insert the Manager Key.
2. Turn the knob to the position.
3. Open the door.

To Lock:

1. Close the door.
2. Turn the knob to the position.
3. Remove the Manager Key.

Note: The Manager Key cannot be inserted or removed when the knob is in the unlocked position.

Reset Instructions

If the door is locked, use the Manager Key to open the door.

1. Using the Manager Key, turn the knob to the position.
2. Remove the Manager Key.
3. Insert the Reset Tool.
4. Push in the Reset Tool and simultaneously turn all dials until they stop.
5. The final code displayed is the current code.
6. Follow instructions to [Assign a User Code](#).

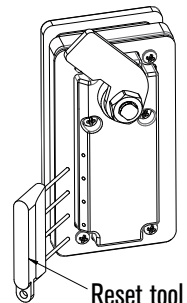

Reset tool

Operate with Assigned User Code

To Unlock:

1. Enter the assigned 4-digit code.
2. Turn the knob to the position.
3. Open the door.

To Lock:

1. Close the door.
2. Turn the knob to the position.
3. Scramble the code.

Change Core Instructions

If the Manager Key is lost or stolen, contact support@digilock.com for a Replacement Set (Manager Key, Programming Key and Cores).

1

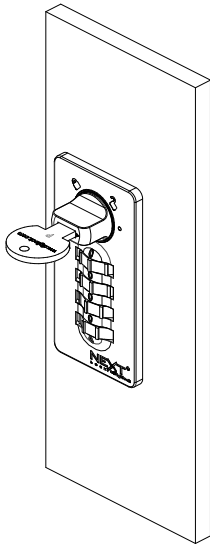

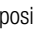
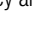
- Set the dial to show the current user code.
- Turn the knob to the  position.
- Insert the programming key and turn the knob to the  position.

2

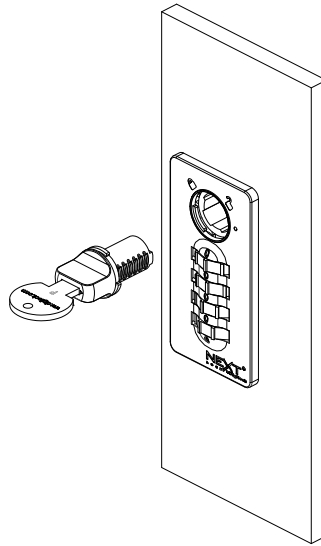

Pull the key to remove the knob and core.

3

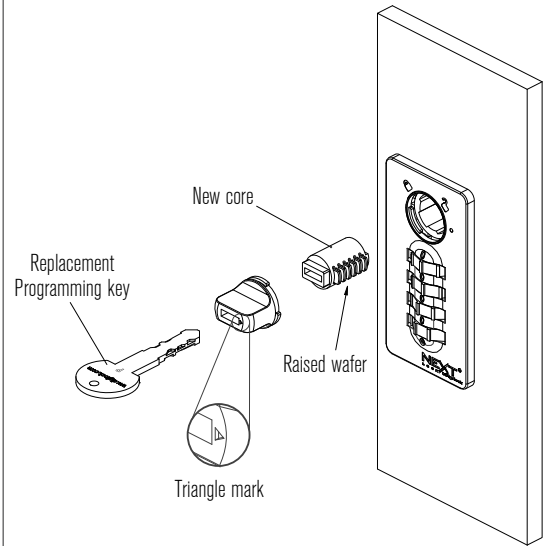

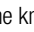
- Insert the replacement programming key into the knob.
- Place a new core on the knob. Align the  mark on the knob with the raised wafers.

4

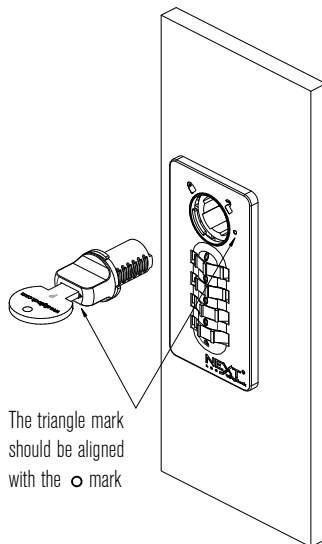

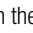
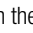

The triangle mark should be aligned with the  mark

- Align the  mark with the  position.
- Insert the new core subassembly into the lock.

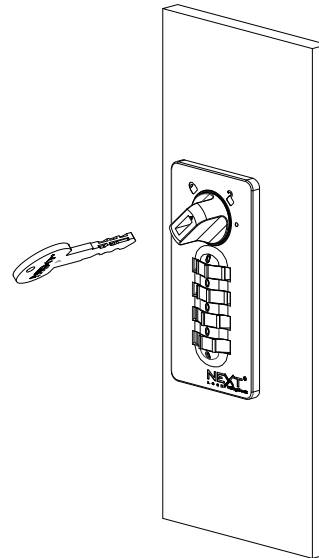
5



- Turn the knob to the  position.
- Remove the replacement programming key.
- Turn the knob to the  position.
- Scramble the code.