



# SenseFace 2A

SIP-Ready Multi-Biometric Access Control Terminal with Video Intercom Capability



Facial Authentication



RFID



Fingerprint



Video Intercom (SIP)

Compatible with



Compatible with

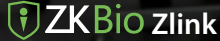

## Introduction

SenseFace 2A adopts the latest intelligent engineering facial authentication. It supports fingerprint, facial, card authentication with large capacity and speedy authentication, adopts ultimate antispoofing algorithm for facial authentication against almost all types of fake photos and videos attack, which offering secure biometric authentication.

SenseFace 2A is an access control terminal featuring a video intercom function and supports ONVIF protocol. It fully improves the video intercom experience and can be compatible with video intercom indoor unit with SIP protocol (version 2.0).

Besides, SenseFace 2A supports multiple communication protocols. Its firmware has AC push and can convert to TA push to , it is compatible with various AC or TA softwares. Also, it can change to BEST protocol to link with ZKBio Zlink (AC module).

## Features

- Visible Light Facial Authentication Technology and ZK Optical Fingerprint Verification
- Multiple Authentication Methods: Facial / Fingerprint / RFID / Password
- Available RFID Modules:125 kHz ID Card / 13.56 MHz IC Card
- HD Video Door Phone Via SIP Protocol (Version 2.0). Compatible With ZKTeco SIP Video Intercom Indoor Monitor (VT07-B01and VT07-B01-W)
- User Data Synchronization: User data can be downloaded/uploaded from one device to another via a USB drive.
- Compatible with wireless doorbell (optional)
- Simple access control functions (Electric Lock; Door Sensor; Exit Button)

\* Download data using the USB driver and make sure to use the FAT32 format.

## Specifications

|   |  |
|---|--|
| Model                                       | SenseFace 2A   |
| Display                                     | 2.4"@ TFT Color LCD Screen (320*240)   |
| Camera                                      | WDR Binocular Camera @ 1MP   |
| Operation System                            | Linux  |
| Hardware                                    | CPU: Dual Core@1GHz<br>RAM: 512MB; ROM: 8GB<br>Speaker: 8ohm @1W<br>Microphone: *1 (Sensitivity: -32 dB / Omni-directional / Signal-to-Noise Ratio: -32 dB/Impedance: 2.2kΩ)<br>Supplement Light: Yes<br>Physical Keypad: 17 Keys<br>Fingerprint Sensor: ZK Optical Sensor   |
| Authentication method                       | Fingerprint / Face / Card / Password (Physical Keypad)   |
| Fingerprint Template Capacity               | 3,000 (1:N) (Standard)   |
| Face Template Capacity                      | 1,500 (1:N) (Standard)   |
| Card Capacity                               | 3,000 (1:N) (Standard)   |
| User Capacity                               | 3,000 (1:N) (Standard)   |
| Transaction Capacity                        | 150,000 (1:N)  |
| Max. User Password Length                   | 8 Digits   |
| Biometric Authentication Speed              | less than 0.5 sec (Fingerprint)<br>less than 0.35 sec (Facial Authentication)  |
| Touchless Biometric Authentication Distance | 30cm to 200cm (Facial Authentication)  |
| False Acceptance Rate (FAR) %               | FAR ≤ 0.01% (Visible Light Facial Authentication)<br>FAR ≤ 0.0001% ( Fingerprint )   |
| False Rejection Rate (FRR) %                | FRR ≤ 0.02% (Visible Light Facial Authentication)<br>FRR ≤ 0.01% (Fingerprint )  |
| Biometric Algorithm                         | ZKFace V4.0<br>ZKFingerprint V13.0 (Standard) /V10.0 (Optional)  |
| Card Type                                   | ID Card@125 kHz (Standard)<br>IC Card@13.56 MHz (Optional)   |
| Communication                               | TCP/IP*1<br>Wi-Fi (IEEE802.11b/g/n/ax) @ 2.4 GHz (Optional)<br>USB: Type A (USB Drive Only )*1<br>Electric Lock*1, Door Sensor*1, Exit Button*1  |
| Standard Functions                          | ADMS, DST, Photo Capture, Event Photo Capture, Up to 14-digit User ID, Access Levels, Groups, Holidays, Record Query, Schedule Bell, Tamper Switch Alarm, Automatic Status Switch, Multiple AuthenticationMethods, SIP Client (Version 2.0), ONVIF (Compatible with Profile S, Profile T, Profile G, Profile C, Profile Q & Profile A), AC Push and TA Push Protocol Switch, HTTPs / SSH Backend Access, T9 Keyboard (Input) |
| Optional Functions                          | IC Card, Wi-Fi, Wireless Doorbell  |
| Power Supply                                | DC 12V 1.5A  |
| Operating Temperature                       | -5°C to 45°C   |
| Operating Humidity                          | 20% to 80% RH (Non-condensing)   |
| Dimensions                                  | 205.20 mm*74.19 mm*33.30 mm (L*W*H)  |
| Net Weight                                  | 0.258 Kg   |
| Supported Software                          | Software: ZKBio CVAccess / ZKBioTime<br>Mobile App.: ZKBio Zlink<br>Cloud Service: ZKBio Zlink   |
| Installation                                | Wall-mount (Compatible with Asian Gang Box / Single Gang Box)  |
| Certifications                              | ISO14001, ISO9001,CE, FCC, RoHS  |

# Configuration

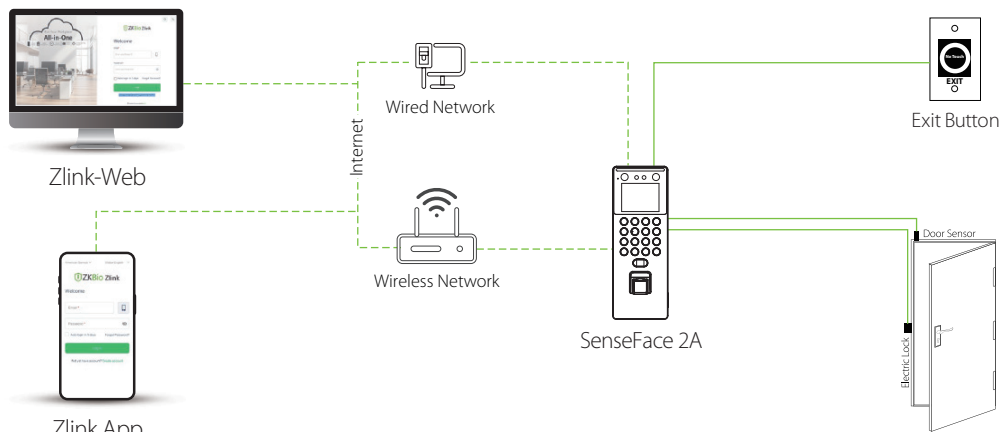

## BEST Protocol

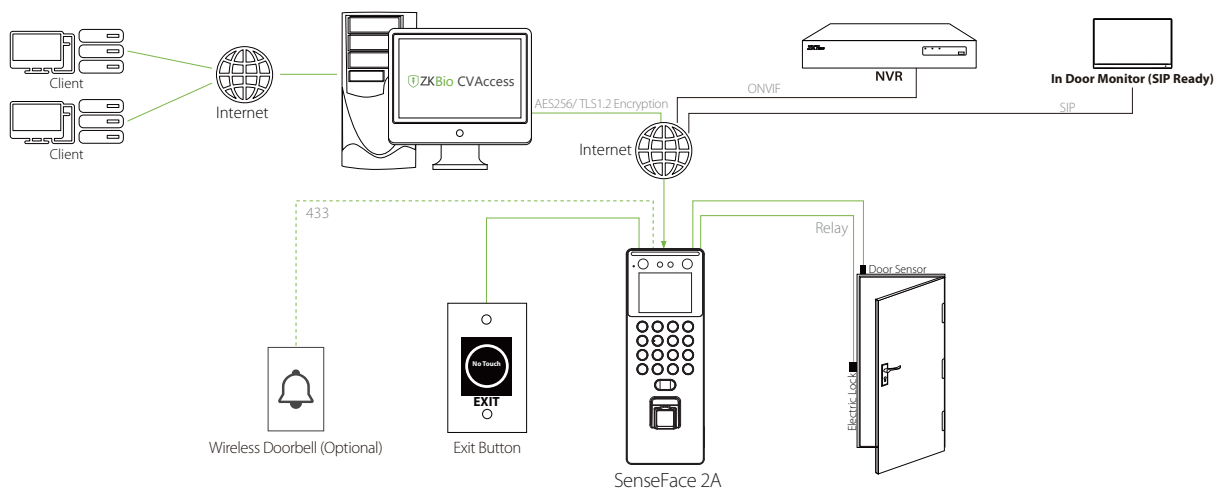

## PUSH Protocol

# Dimensions (mm)

